

Retrofit Non-Return Valve



Flexseal's range of retrofit Non-Return Valves (NRV's) can be installed directly into existing manholes by simply pushing the NRV into the desired pipe inlet. The product prevents foul water flowing back from the blocked sewerage systems to flood the property from the inside via toilets, plug holes and waste pipes.

The Retrofit NRV's can be fitted in minutes and do not require any specialist expertise or equipment.

Users also benefit from protection against rodent infestation. The stainless steel reinforced flap helps to block rats and other rodents and insects from travelling up pipes and into homes and commercial buildings.

Benefits

- Simple push-fit installation into existing manhole
- Unobtrusive when installed
- Two sizes available to suit DN100 and DN150 pipes
- Universal for all pipe materials within the products size range
- Protects against back flow and pests, such as rats and other rodents
- Stainless steel reinforced flap for added protection against rodent infestation
- WRc Approved

Product Range

Product Code	Description
NRV100	DN100 / 100mm Non Return Valve Fits pipes with an ID between 97-106mm
NRV150	DN100 / 100mm Non Return Valve Fits pipes with an ID between 148-153mm

Installation Steps

1. When opening an inspection chamber or manhole you must take the necessary safety precautions.
2. Lifting the manhole cover: this may take two people as it can be heavy.
3. Once the manhole cover is lifted, determine the direction of flow. This can be determined by flushing a toilet in the property.
4. You will need to fit Non Return Valves to each of the flow pipes from the property.
5. DO NOT install on the outlet of the chambers (where the water flows to) as this will cause a blockage. Only install NRV's on the chamber inlets.
6. Clean out the incoming pipes of any debris.
7. Take the NRV out of the box, put on gloves and push the NRV up the pipe inlet mouth. Use pipe lubricant sparingly if required.
8. Make sure the valve is positioned correctly in the pipe, with the flap position downwards and the hinge pivot point horizontal.
9. Ensure the locking mechanisms are unlocked for normal use.

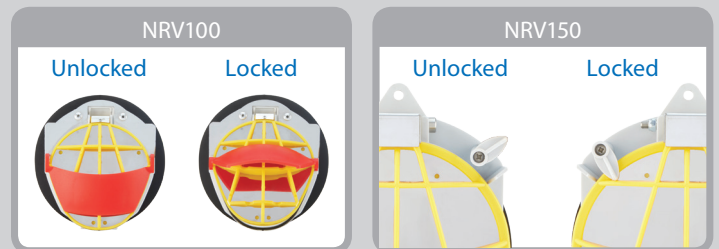

NRV100: Fits all pipe materials measuring DN100 / 4" with an internal diameter between 97-106mm

NRV150: Fits all pipe materials measuring DN150 / 6" with an internal diameter between 148-153mm

